

510 series Guitar Bridge 510FB

INSTALLATION

1. Drive the driving nut ⑤ into guitar body.
2. Put stud bolt ⑥ into driving nut ⑤ with adjustment of locking screw ⑦ located in stud bolt ⑥ not to come out from the bottom of stud bolt ⑥.
3. Loosen the moving screws ③ and ④ respectively and put the bridge on to stud ⑥. Then tighten the moving screws ③ and ④.

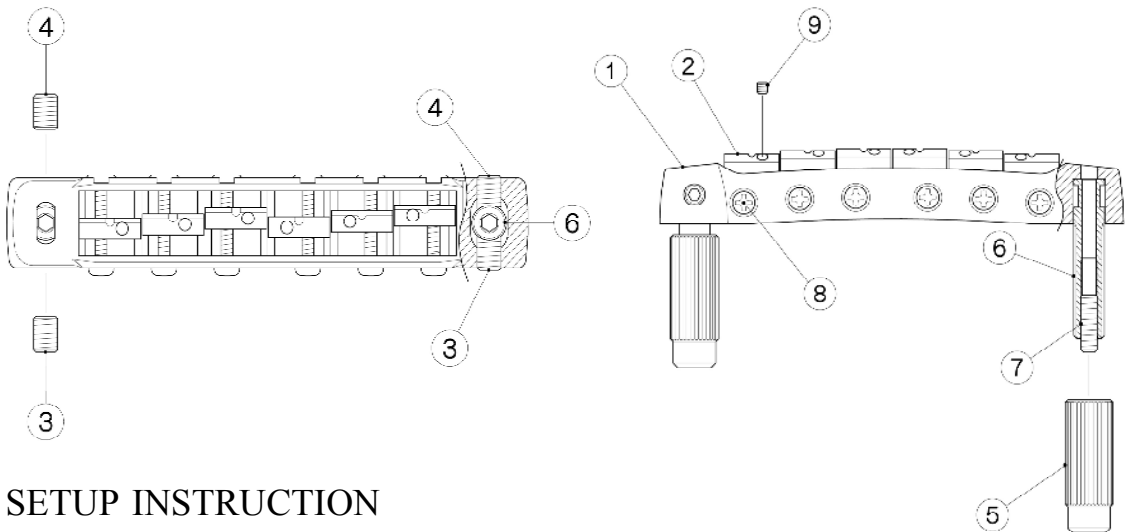

SETUP INSTRUCTION

I. Up-and-down adjustment

Loosen the locking screw ⑦ located in the stud bolt ⑥ and also loosen the adjust screw ③ then adjust the main body up and down. When finished, be sure to retighten the screws ⑦ and ③.

II. Back-and-forth adjustment

1. To adjust to forth, loosen the moving screw ④ on left and right, then tighten the moving screw ③ on both sides.
2. To adjust to back, loosen the moving screw ③ on left and right, then tighten the moving screw ④ on both sides. Be sure the screws ③ and ④ stay tight without any rattling when finished.

Note: In either case 1 and 2, do it right and left in turn little by little as you may break a movable part if one side only is moved a lot.

It is available for move 1.5mm from center to back and forth.

III. Intonation adjustment

To adjust saddle position, loosen the locking screw ⑨ and move the saddle by adjusting screw ⑧. Be sure to retighten the locking screw ⑨ after finished.